

Technical drawing of a T6 bolt and nut assembly. The top part shows a cross-section of a bolt with dimensions: diameter 3/16, length 20/50, and a hexagonal head with width 15.58. The bottom part shows a side view of the bolt and nut assembly with dimensions: bolt diameter 3/16, nut length 2.54, and bolt length 20/370. The bolt is labeled 'T6' and the nut is labeled 'NUT'.

[illegible]

ΔΙΑΤΑΞΗ ΟΠΛΙΣΜΟΤ ΝΕΩΝ ΔΟΚΩΝ ΝΔΣ

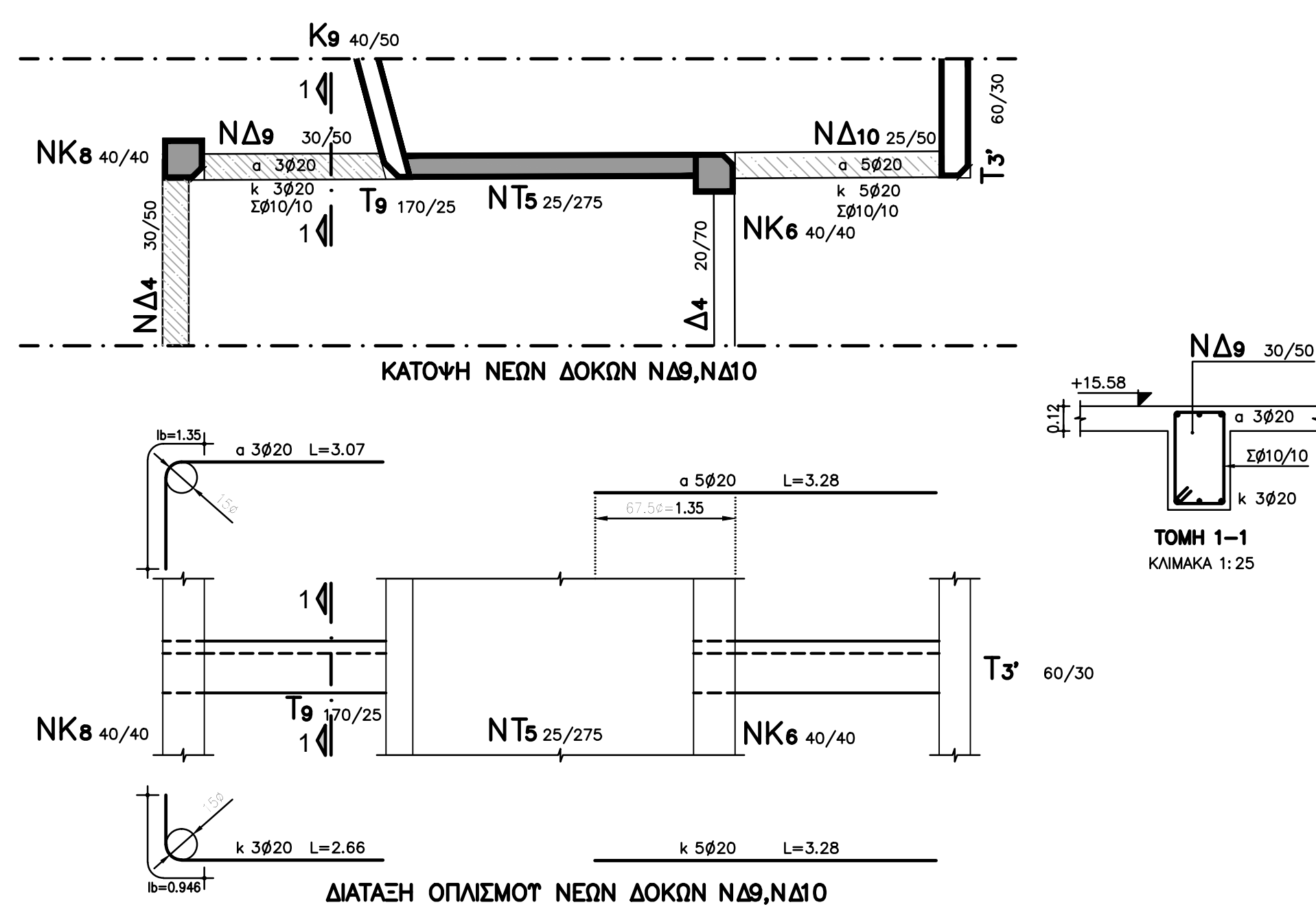
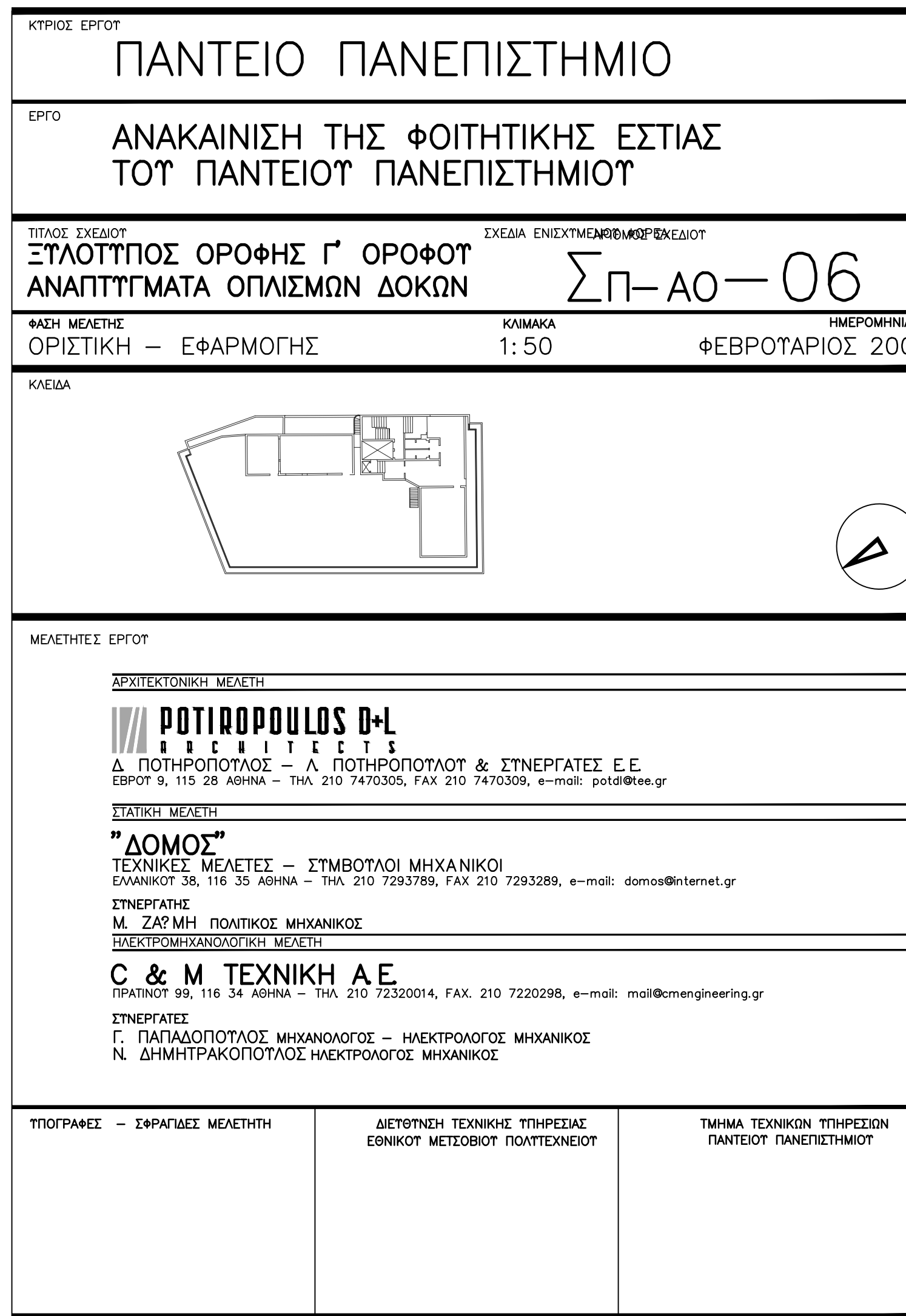
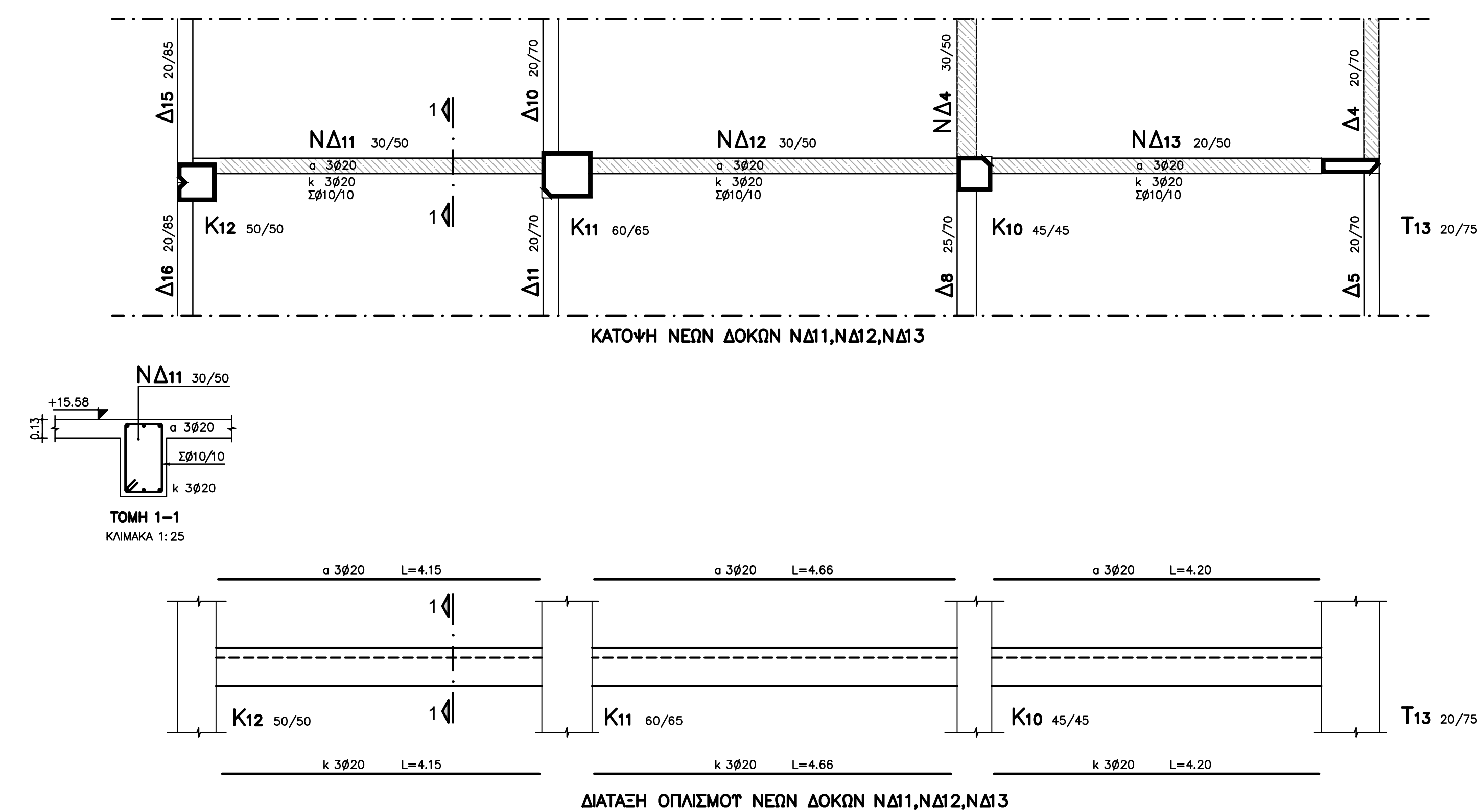

Technical drawing of a reinforced concrete slab (K15) and its connection to a wall (K14) and another slab (NΔ15). The drawing shows a cross-section of the slab with dimensions and reinforcement details. Key dimensions include a slab thickness of 20/70, a wall height of 25/70, and a slab width of 30/50. Reinforcement includes top bars (NΔ30, NΔ15, NΔ10) and bottom bars (K15, K14). The drawing also shows a detail of the slab connection to the wall, with dimensions like 15.58 and 0.12.

ΔΙΑΤΑΞΗ ΟΠΛΙΣΜΟΤ ΝΕΩΝ ΔΟΚΩΝ ΝΔ30,ΝΔ15